



**DEPARTMENT OF THE ARMY**  
SAN FRANCISCO DISTRICT, U.S. ARMY CORPS OF ENGINEERS  
450 GOLDEN GATE AVENUE  
SAN FRANCISCO, CALIFORNIA 94102-3404

Operations and Readiness Division

**PUBLIC NOTICE**

**REQUEST FOR PERMISSION TO ALTER A U.S. ARMY CORPS OF ENGINEERS  
PROJECT UNDER SECTION 408**

**TITLE:** Pajaro River College Lake Pipeline, 408-SPN-2022-0001

Public notice comment period:

Begins: July 20, 2022

Ends: August 19, 2022

**REQUESTER:** In compliance with U.S.C. Title 33, Chapter 9, Subchapter 1, Section 408, Pajaro Valley Water Management Agency (PV Water), (requester) has requested permission through Santa Cruz County Flood District (non-federal sponsor of the federally authorized project) from the U.S. Army Corps of Engineers (USACE) to alter the Pajaro River Project, an existing federal flood risk management project, authorized by Section 10 of the Flood Control Act of December 1944.

**LOCATION:** Project is located adjacent to Salsipuedes Creek, in the City of Watsonville, Santa Cruz County, California. (see attachment 1)

**REQUESTER'S PROPOSED ACTION:** As part of the larger College Lake Integrated Resources Management Project, PV Water proposes to install the College Lake Pipeline along an approximately 6-mile route. The installation of the College Lake Pipeline includes the trenchless installation of a 30-inch-diameter high-density polyethylene (HDPE) pipe (or 25.5-inch welded steel pipe) under Salsipuedes Creek, approximately 350 meters upstream of the confluence with the Pajaro River. The proposed project would tunnel the pipeline with fifteen feet minimum cover from the invert of Salsipuedes Creek. (Attachment 2)

**ENVIRONMENTAL IMPACTS OF PROPOSED ACTION:** Salsipuedes Creek is a major tributary of the Pajaro River flowing through a series of high grassy terraces contained by levees. The stream bottom is generally grassy, due to regular clearing of woody vegetation by Santa Cruz County Flood Control District, Zone 7, to reduce channel roughness and maintain hydraulic capacity. There is sparse tree cover outside the levees. The proposed pipeline crossing on Salsipuedes Creek would occur just north of the Riverside Drive bridge crossing. This portion of Salsipuedes Creek contains some shrubs but is dominated by grasses. The area outside the levees contains commercial properties. The proposed trenchless pipeline installation would have the pipeline

horizontally drilled below the creek and installation pits would be located outside the levees and within existing commercial properties.

USACE determined there is no suitable habitat for federally listed species under the jurisdiction of the U.S. Fish and Wildlife Service (USFWS) or the National Marine Fisheries Service (NMFS) in the vicinity of the project. Therefore, USACE determined there would be no effects to federally listed species, designated critical habitat, or essential fish habitat under the jurisdiction of the USFWS and/or NMFS.

After an initial review, USACE has determined no eligible or potentially eligible cultural resources may be affected by the proposed project. USACE will initiate consultation with the State Historic Preservation Officer and Native American Tribes under Section 106 of the National Historic Preservation Act, as appropriate.

Upon review of the Section 408 application and other supporting documentation, USACE has made a preliminary determination that the project may qualify for a Categorical Exclusion and would not require the preparation of an Environmental Impact Statement for the purposes of NEPA.

**AUTHORITY:** The authority to grant permission for temporary or permanent use, occupation, or alteration of any USACE civil works project is contained in Section 14 of the Rivers and Harbors Act of 1899, as amended (33 U.S.C 408) ("Section 408"). Section 408 authorizes the Secretary of the Army, on the recommendation of the Chief of Engineers, to grant permission for the alteration or occupation or use of a USACE project if the Secretary determines that the activity will not be injurious to the public interest and will not impair the usefulness of the project. The Secretary of Army's authority under Section 408 has been delegated to the USACE, Chief of Engineers. The USACE Chief of Engineers has further delegated the authority to the USACE, Directorate of Civil Works and Division and District Engineers, depending upon the nature of the activity.

**LIMITS OF SECTION 408 AUTHORITY:** A requester has the responsibility to acquire all other permissions or authorizations required by federal, state, and local laws or regulations, including any required permits from the USACE Regulatory Program under Section 10 of the Rivers and Harbors Act of 1899 (33 U.S.C. 403), Section 404 of the Clean Water Act (33 U.S.C. Section 1344), and/or Section 103 of the Marine Protection, Research and Sanctuaries Act of 1972 (33 U.S.C. 1413). In addition, an approval under Section 408 does not grant any property rights or exclusive privileges nor does it authorize any injury to the property or rights of others.

**EVALUATION FACTORS:** The decision whether to grant the requested permission for project alteration under Section 408 will be based on several factors. That decision will reflect the national concern for both protection and utilization of important resources. The benefit which reasonably may be expected to accrue from the proposal must be balanced against its reasonably foreseeable detriments. Review of requests for

alteration will be reviewed by a USACE technical review team considering the following factors:

1) Impair the Usefulness of the Project Determination. The review team will determine if the proposed alteration would limit the ability of the USACE project to function as authorized, or would compromise or change any authorized project conditions, purposes or outputs. In order for an alteration to be approved, the requester must demonstrate that the alteration does not impair the usefulness of the federally authorized project.

2) Injurious to the Public Interest Determination. Proposed alterations will be reviewed to determine the probable impacts, including cumulative impacts, on the public interest. Factors that may be relevant to the public interest evaluation depend upon the type of USACE project being altered and the nature of the proposed alteration and may include, but are not limited to, such things as conservation, economic development, historic properties, cultural resources, environmental impacts, water supply, water quality, flood hazards, floodplains, residual risk, induced damages, navigation, shore erosion or accretion, and recreation. This evaluation will consider information received from the interested parties, including tribes, agencies, and the public. The benefits that reasonably may be expected to accrue from the proposal must be compared against its reasonably foreseeable detriments. The decision whether to approve an alteration will be determined by the consideration of whether benefits are commensurate with risks and by the net impact of the alteration on the public interest using the public interest factors.

3) Environmental Compliance. A decision on a Section 408 request is a federal action, and therefore subject to the National Environmental Policy Act (NEPA) and other environmental compliance requirements. While USACE is responsible for ensuring environmental compliance, the requester is responsible for providing all information that the San Francisco District identifies as necessary to satisfy all applicable federal laws, executive orders, regulations, policies, and procedures. NEPA and other analysis completed to comply with other environmental statutes (e.g. Endangered Species Act) should be commensurate with the scale and potential effects of the activity that would alter the USACE project. The San Francisco District will work with the requester to determine the requirements, which will be scaled to the likely impacts of the proposed alteration and should convey the relevant considerations and impacts in a concise and effective manner. The final NEPA analysis will normally address the direct, indirect, and cumulative impacts that result from activities resulting in the temporary or permanent use, occupation, or alteration of any USACE civil works project. The final NEPA analysis will be incorporated in the decision documentation that provides the rationale for issuing or denying a Section 408 permission for the project. The final NEPA analysis and supporting documentation will be on file with the San Francisco District, Operations and Readiness Division.

**PUBLIC INVOLVEMENT:** The purpose of this notice is to solicit comments from the public; federal, state, and local agencies and officials; tribes; and other interested parties

regarding the College Lake Pipeline, a proposed alteration to an existing federally authorized project. Comments received within 30 days of publication of this notice will be used in the evaluation of potential impacts of the proposed action on important resources and in the evaluation of whether the proposed alteration would be injurious to the public interest and/or would impair the usefulness of the authorized project. Only the specific activities that have the potential to occupy, use or alter the Pajaro River Project will be evaluated. Please limit comments to the area of the alteration and those adjacent areas that would be directly or indirectly affected by the alteration to the Pajaro River Project. Please note that all comment letters received are subject to release to the public through the Freedom of Information Act.

**SUBMITTING COMMENTS:** Written comments, referencing 408-SPN-2022-0001 must be submitted to the office listed below on or before May 3, 2022.

Jessica Vargas, 408 Coordinator  
U.S. Army Corps of Engineers, San Francisco District  
Operations and Readiness Division  
450 Golden Gate Avenue, 4<sup>th</sup> Floor, Room 1111  
San Francisco, California 94102-3404

Email: *spn.operationsdivision@usace.army.mil*

**ATTACHMENTS:** Vicinity map, location map, and proposed project footprint in relation to federal project.



SOURCE: ESA, 2021

College Lake Integrated Resources Management Project - Addendum

**Figure 1**  
Vicinity Map



SOURCE: Jacobs, 2021; ESA, 2021

College Lake Integrated Resources Management Project - Addendum

**Figure 2**  
Location Map



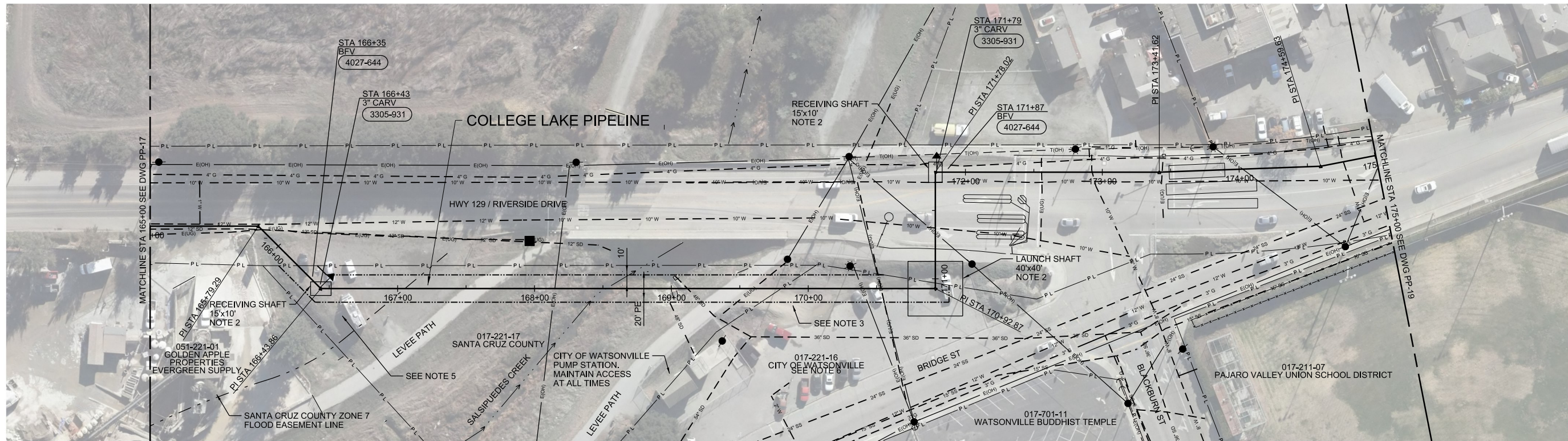

**NOTES:**

- SHAFT SIZES SHOWN ARE FOR REFERENCE ONLY. CONTRACTOR TO DETERMINE THE REQUIRED SHAFT SIZES SUITABLE FOR TUNNELING EQUIPMENT AND TO STAY WITHIN TEMPORARY CONSTRUCTION EASEMENT.
- SUGGESTED SEQUENCE OF TUNNELING:
  - TUNNEL ACROSS HWY 129 FIRST. LAUNCH SHAFT AND RECEIVING SHAFT INVERT ELEVATIONS SHOWN ARE FOR REFERENCE ONLY. CONTRACTOR TO DETERMINE THE REQUIRED SHAFT INVERT DEPTHS SUITABLE FOR TUNNELING EQUIPMENT WHILE MAINTAINING THE REQUIRED MINIMUM CLEARANCE AND ALIGNMENT LINE AND GRADE SHOWN.
  - TUNNEL ACROSS SALSIPUEDES CREEK SECOND. CONTINUE LAUNCH SHAFT CONSTRUCTION BY EXCAVATING DOWN TO THE APPROPRIATE ELEVATION. LAUNCH SHAFT AND RECEIVING SHAFT INVERT ELEVATIONS SHOWN ARE FOR REFERENCE ONLY. CONTRACTOR TO DETERMINE THE REQUIRED SHAFT INVERT DEPTHS SUITABLE FOR TUNNELING EQUIPMENT WHILE MAINTAINING THE REQUIRED MINIMUM CLEARANCE AND ALIGNMENT LINE AND GRADE SHOWN.
- LEVEE ACCESS. MAINTAIN ACCESS AT ALL TIMES.
- PROTECT UTILITIES IN PLACE. COORDINATE SHAFT LOCATION AND SHORING INSTALLATION AND REMOVAL WITH UTILITY COMPANIES. POTHOLE ALL EXISTING UTILITIES WITHIN BORE PATH AND VERIFY WITH UTILITY INSPECTORS PRIOR TO START OF TUNNELING.
- COORDINATE TEMPORARY WORK SPACE WITHIN FLOOD EASEMENT AND PROPERTY LINES WITH SANTA CRUZ COUNTY.
- COORDINATE TEMPORARY WORK SPACE WITHIN PROPERTY LINES AND BRIDGE STREET WITH THE CITY OF WATSONVILLE.

SEE DWG PP-18A FOR PROFILE

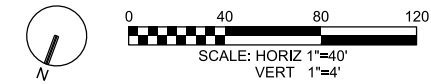

REGISTERED PROFESSIONAL ENGINEER  
 KIMBERLY MARIA HEIN CIVIL  
 LICENSE NO. C69208  
 STATE OF CALIFORNIA  
 NOT FOR CONSTRUCTION

NO.	DATE	REVISION	BY	APVD

2525 AIRPARK DR  
 REDDING, CA 96001  
 (530) 243-5831  
 COLLEGE LAKE PIPELINE  
 SANTA CRUZ COUNTY  
 PAJARO VALLEY WATER MANAGEMENT AGENCY  
 WATSONVILLE, CA

CIVIL  
 PLAN  
 STA 165+00 TO STA 175+00

AS SHOWN
VERIFY SCALE
BAR IS ONE INCH ON ORIGINAL DRAWING.
DATE FEBRUARY 2022
PROJ W8Y08700
DWG PP-18
SHEET 27 of 61

REUSE OF DOCUMENTS: THE DOCUMENT, AND THE IDEAS AND DESIGNS INCORPORATED HEREIN, AS AN INSTRUMENT OF PROFESSIONAL SERVICE, IS THE PROPERTY OF JACOBS AND IS NOT TO BE USED, IN WHOLE OR IN PART, FOR ANY OTHER PROJECT WITHOUT THE WRITTEN AUTHORIZATION OF JACOBS.  
 © JACOBS 2020. ALL RIGHTS RESERVED.

**JACOBS**  
 PRELIMINARY - NOT FOR CONSTRUCTION

NOTES:

- CAUTION! ADHERE TO OSHA AND UTILITY CLEARANCE REQUIREMENTS.
- PG&E DOES NOT PROVIDE DEPTH INFORMATION ABOUT THEIR EXISTING ELECTRIC AND GAS FACILITIES. PER PG&E, UNDERGROUND FACILITIES ARE GENERALLY 24 TO 36-INCHES DEEP. DEPTH IS SHOWN TO BE 36-INCHES AND WILL NEED TO BE VERIFIED AT LEAST 48 HOURS PRIOR TO ANY EXCAVATION THROUGH USA (811). A STANDBY PG&E EMPLOYEE IS REQUIRED DURING ANY EXCAVATION WITHIN 10 FEET OF A GAS TRANSMISSION LINE.
- SHAFT SIZES SHOWN ARE FOR REFERENCE ONLY. CONTRACTOR TO DETERMINE THE REQUIRED SHAFT SIZES SUITABLE FOR TUNNELING EQUIPMENT AND TO STAY WITHIN TEMPORARY CONSTRUCTION EASEMENT.
- SUGGESTED SEQUENCE OF TUNNELING:  
 A. TUNNEL ACROSS HWY 129 FIRST. LAUNCH SHAFT AND RECEIVING SHAFT INVERT ELEVATIONS SHOWN ARE FOR REFERENCE ONLY. CONTRACTOR TO DETERMINE THE REQUIRED SHAFT INVERT DEPTHS SUITABLE FOR TUNNELING EQUIPMENT WHILE MAINTAINING THE REQUIRED MINIMUM CLEARANCE AND ALIGNMENT LINE AND GRADE SHOWN.  
 B. TUNNEL ACROSS SALSIPUEDES CREEK SECOND. CONTINUE LAUNCH SHAFT CONSTRUCTION BY EXCAVATING DOWN TO THE APPROPRIATE ELEVATION. LAUNCH SHAFT AND RECEIVING SHAFT INVERT ELEVATIONS SHOWN ARE FOR REFERENCE ONLY. CONTRACTOR TO DETERMINE THE REQUIRED SHAFT INVERT DEPTHS SUITABLE FOR TUNNELING EQUIPMENT WHILE MAINTAINING THE REQUIRED MINIMUM CLEARANCE AND ALIGNMENT LINE AND GRADE SHOWN.
- CITY OF WATSONVILLE WATER MAINS STANDARD ARE 42-INCHES MINIMUM AND 48-INCHES MAXIMUM. DEPTH IS SHOWN TO BE 42-INCHES MINIMUM.

SEE DWG PP-18 FOR PLAN

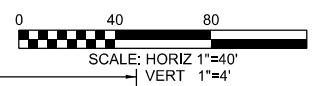
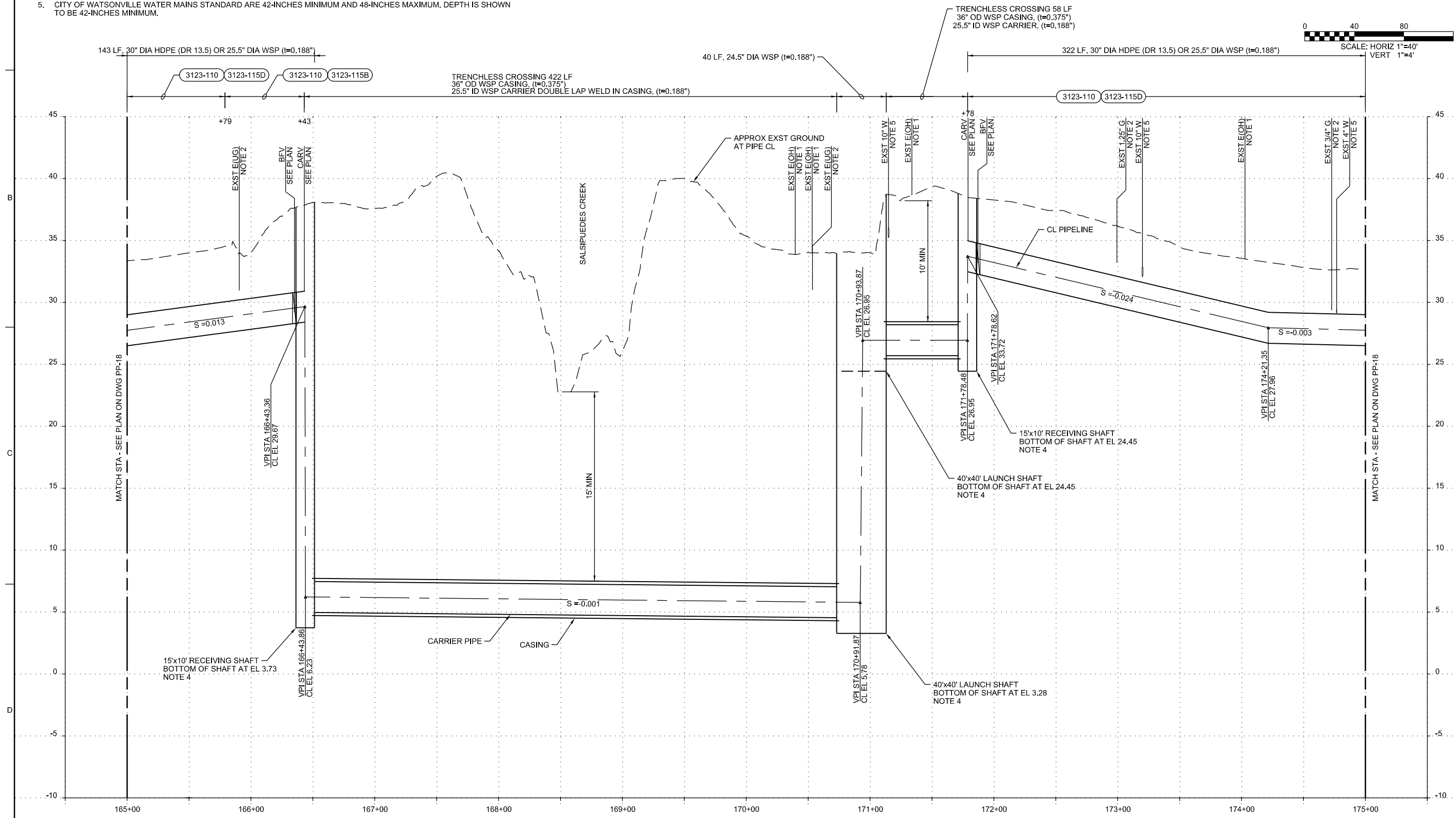

REGISTERED PROFESSIONAL ENGINEER  
 KIMBERLY MARIA HEIN  
 CIVIL  
 LICENSE NO. C69208  
 STATE OF CALIFORNIA

NOT FOR CONSTRUCTION

NO.	DATE	REVISION	BY	APVD
			J. SMITH	APVD
			J. MESTEMACHER	CHK
			C. MERCADO	DR

2525 AIRPARK DR  
 REDDING, CA 96001  
 (530) 243-5831

COLLEGE LAKE PIPELINE  
 SANTA CRUZ COUNTY  
 PAJARO VALLEY WATER MANAGEMENT AGENCY  
 WATSONVILLE, CA

**Jacobs**

CIVIL  
 PROFILE  
 STA 165+00 TO STA 175+00

AS SHOWN  
 VERIFY SCALE  
 BAR IS ONE INCH ON ORIGINAL DRAWING.  
 0 1"

DATE	FEBRUARY 2022
PROJ	W8Y08700
DWG	PP-18A
SHEET	28 of 61

PRELIMINARY - NOT FOR CONSTRUCTION